

October 2023 Release Notes

Version 3.0.40

This release brings exciting updates like e-prescribing with iKnowMed mobile, self-service reporting, and further improvements to the enhanced Orders Queue. There are also important fixes and other minor enhancements.

E-Prescribe using iKnowMed mobile

Send new medication prescriptions, including Schedule 2 drugs, straight to the pharmacy using the latest version of iKnowMed Mobile to save time and have patients' prescriptions ready faster.

This information will sync with the desktop version of iKnowMed to ensure you're always working with real-time information.

The app also provides and syncs with the lists of a patient's past and active medications and their previously ordered medications from the desktop version of iKnowMed.

How to prescribe using the app:

1. After your access is properly set, you can create orders in the app.

NOTE: iKnowMed mobile does not currently support approving or denying renewals. You may only place new orders using the app.

2. Open a patient's chart and scroll to the **Medications** section. Tap the **New Order** link (callout 1).
 - a. You may also place new orders on the page that lists the patient's Active medications. Simply tap the plus sign in the upper right corner and select New Order from the drop-down.

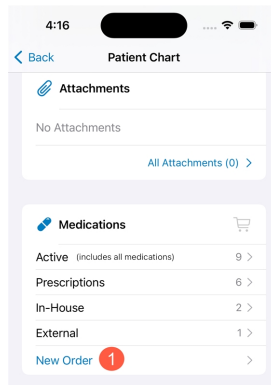

3. On the **New Order** page, use the search bar at the top to locate a medication (callout 2) or tap on and re-order a medication from the **Previously Ordered Medications** list (callout 3).

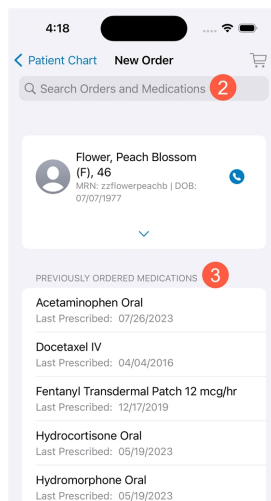

4. Once a medication is selected, you will land on the **Create Order** page.
5. From here, you may tap on each item to add or edit the information, such as the Form, Dose, Dose Unit, Route, Frequency, etc.

NOTE: This version of iKnowMed Mobile does not allow the formula dose value to be changed for medications that default to a formula dose. You may change the dose field in the app but changes to the actual formula dosing are not available at this time.

6. Once all the information is complete, tap **Add to Cart** (callout 4).

7. You will return to the **New Order** page where you may add more medications if needed.
8. To see the medications in your cart or to complete your order, click the cart icon in the upper-right corner of the screen (callout 5).

9. The cart will display the patient's information at the top followed by the order.
10. To edit an order in the cart, simply tap the medication name (callout 6) to return to the Create Order page.
11. You may delete items from the order using the red trash can icon associated with each item (callout 7).
12. To complete the order, scroll to the bottom and tap **Sign with PIN or Password** (callout 8).

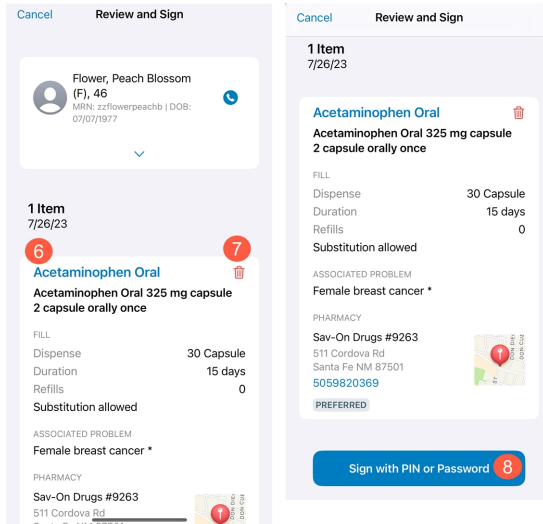

13. On the pop-up window, enter your PIN or password and tap **Sign** (callout 9).

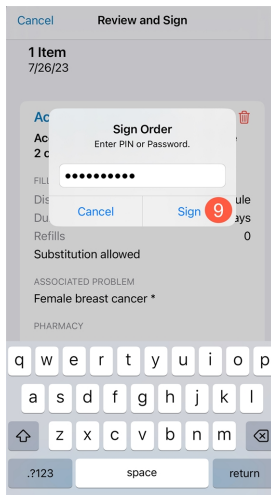

14. If successful, you will receive a message that your order is complete.

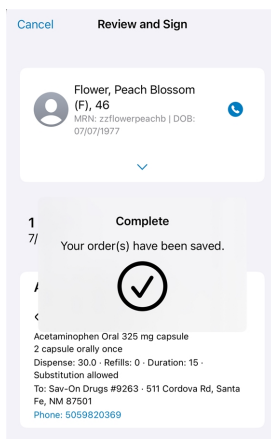

15. For controlled substances, you must complete two-factor authentication (2FA) to complete the order. [1](#)
16. Scroll to the bottom of the 2FA screen and tap **Authenticate** (callout 10).



17. On the **Authentication** page, tap on your preferred 2FA method from push notification, soft token passcode, or hard token passcode (callouts 11-13).

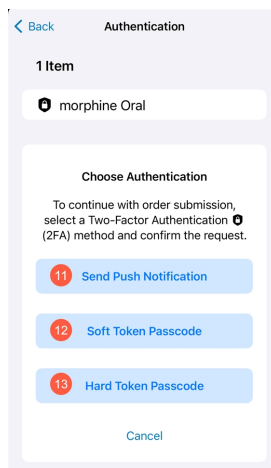

18. You will then land on an intermediary page until you complete your 2FA.
19. If successful, you will receive a message that your order is complete.

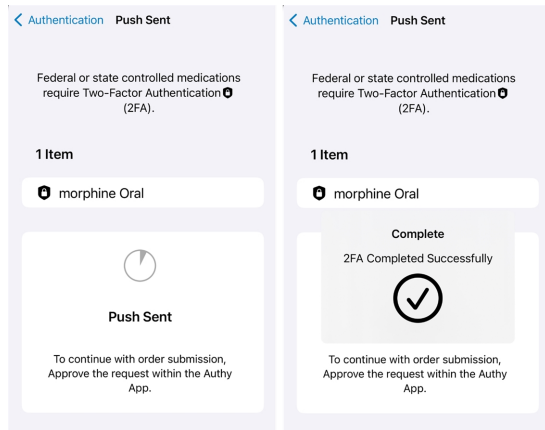

Improvements to the enhanced Orders Queue

In this release, we made several enhancements to improve the workflow and experience of those working in the enhanced Orders Queue. Here are the key changes:

Enhanced Insurance Display

The patient card in each order has been updated to provide a clearer view of patient insurance information. Now, only active and unexpired insurers will be displayed in the Insurance field (callout 1). This improvement helps you focus on the most relevant patient insurance details.

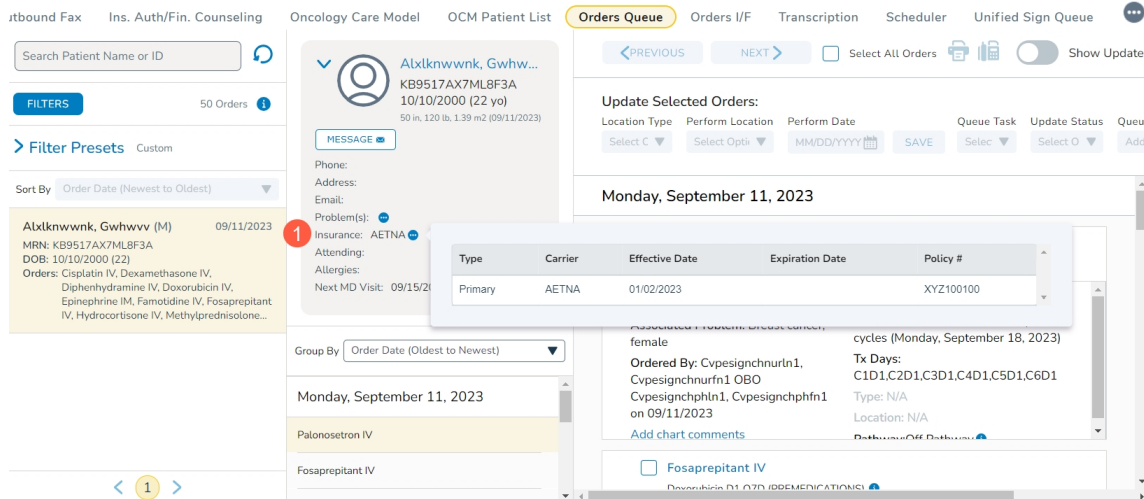

Next MD Visit Clarity

We refined the Next MD Visit field in the patient card to display only upcoming provider visits (callout 2). This ensures that you have quick access to the most

pertinent information about the patient's upcoming appointments.

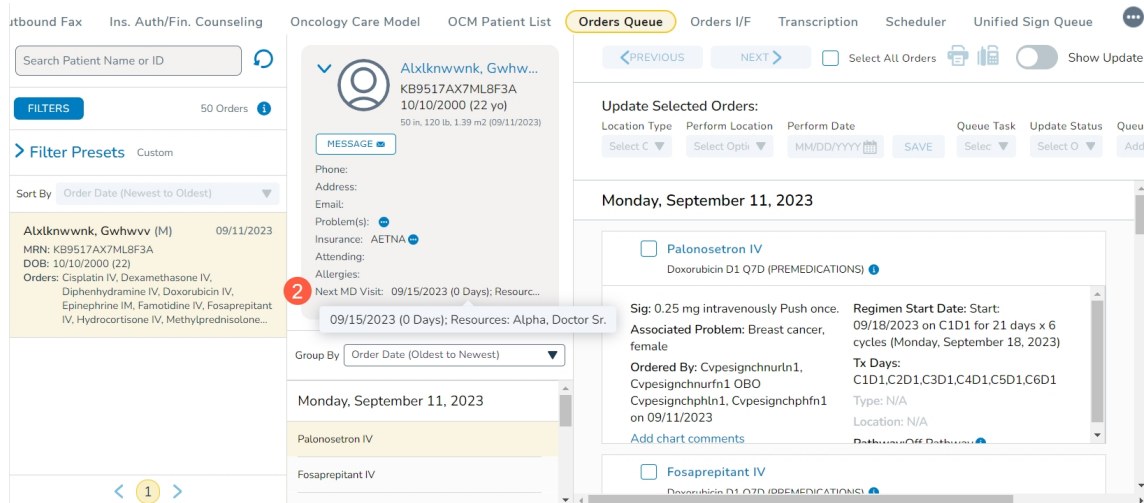

Order Queue Improvements for Repeating Series

A significant enhancement has been introduced to the Orders Queue. Now, a separate order card will appear for each order created as part of a repeating series, e.g., CBC every 2 weeks x 3. This update empowers schedulers to apply the correct performance date and location to each order individually, enhancing precision in scheduling. Notably, the issue where an extra order card appeared for repeating orders has been resolved with this release.

Visible Order Status

We improved visibility by displaying who sent the order to the Orders I/F queue and when directly on the order card in the enhanced Orders Queue. The **Sent to I/F by** field (callout 3) aids schedulers and other users of the queue in making informed decisions regarding the handling of each order.

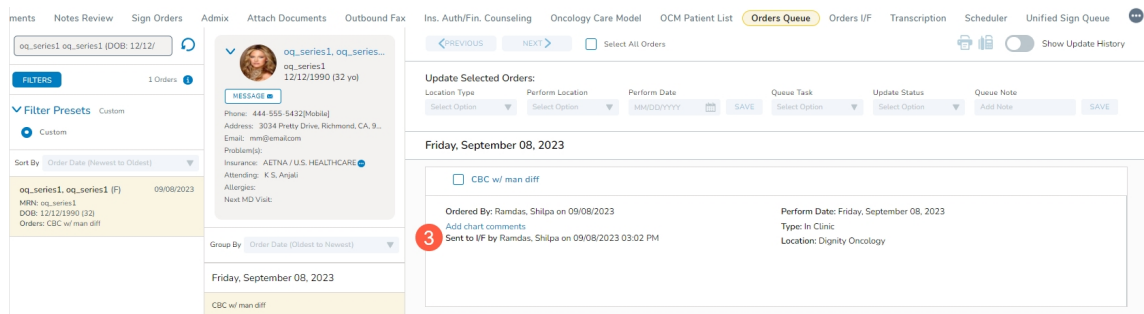

Additional Enhancements (A-Z)

Admin > Reports

The search logic for filter items with Enter Any Value entry has been updated. Previously, users could input up to 5 values using a comma (",") with no spaces in between. However, with the recent changes, users should now input up to 5 values using a pipe ("|") with no spaces in between.

These changes will impact the following reports and their respective filters:

1. Order Report:
 - Filter Affected: Order Description
2. Diagnosis Report:
 - Filters Affected: ICD 10 Code & Description and Diagnosis/Problem Name
3. Charge Capture Report:
 - Filter Affected: Description

Please make sure to use the pipe going forward to ensure accurate searching within these reports.

Chart Summary > Release of Information

We updated the Release of Information Audit Report in iKnowMed to include the Progress Note (CCDA) sent from iKnowMed to a requestor via the Carequality network. Notably, this includes the inclusion of the Message ID, providing improved traceability and information tracking.

Clinical Profile > Care Plan

Those using the VBC Care Plan will now see (Retired) next to the Anthem Oncology Medical Home for patients with existing VBC Care Plans. Furthermore, newly created VBC Care Plans will no longer display the Anthem Oncology Medical Home program as an option. This update ensures clarity and aligns with program changes.

Documents tab

To improve the distinction between documents in iKnowMed, we introduced a new feature for documents imported from Carequality via the External Records

tab. These documents will now be accompanied by an icon that clearly indicates their origin as an external source. This enhancement easily differentiates between documents scanned and attached or created within iKnowMed and those imported via Carequality.

Nursing Care > Discharge Note

When the Time of Day format is configured as 24 Hour in Practice Preferences, this setting will affect how time is presented in the Discharge Note. Specifically, users can enter and view times in the 24-hour format. Consequently, the Discharge Note section within the Nurse Note will also display time in this same 24-hour format. This alignment ensures consistency in time representation across relevant sections of the application.

Worklist Queues > Unified Sign Queue

After this release, you will find a single, consolidated option in the Worklist Queues menu for the Unified Sign Queue. When you select this option, you will access the enhanced Unified Sign Queue, which makes the process of signing all labs, imaging, orders, and other documents for individual patients more efficient and user-friendly.

Fixed Defects (A-Z)

Clinical Profile > Care Plan

Previously, the Enhancing Oncology Model (EOM) tab in the VBC Care Plan required the EOM program to be the first program in the plan to populate correctly. We have resolved this issue, and now, the EOM program can appear in any order within a patient's VBC Care Plan. This allows for greater flexibility in designing care plans while still ensuring access to the EOM tab.

Clinical Profile > Chart Alerts

When users moved a chart alert from active to inactive, the icon options required a manual action to be de-selected, causing the continued display of icons on the patient chart and the Visit List. We resolved this issue, and now, the icon options will automatically deselect when a chart alert is marked as inactive. As a result, the icons will no longer appear in the patient chart and on the Visit List when a chart alert is inactive, ensuring a cleaner and more intuitive user experience.

Orders > Regimens > Drafts

Previously, when accessing a regimen order draft from Orders > Regimens, adjustments saved to the order amount reverted to the calculated order dose. This defect has been successfully resolved. Now, when you adjust the order amount in a regimen order, these adjustments are retained in the regimen draft available in Order > Regimens.